

Metal Pin Anchor

Head Style: Mushroom Head

Body Type: All Metal

Material: Carbon Steel

Class Grade: Low Tensile Grade 2

Material Finish: Zinc Alloy

Corrosion Protection Level: Moderate

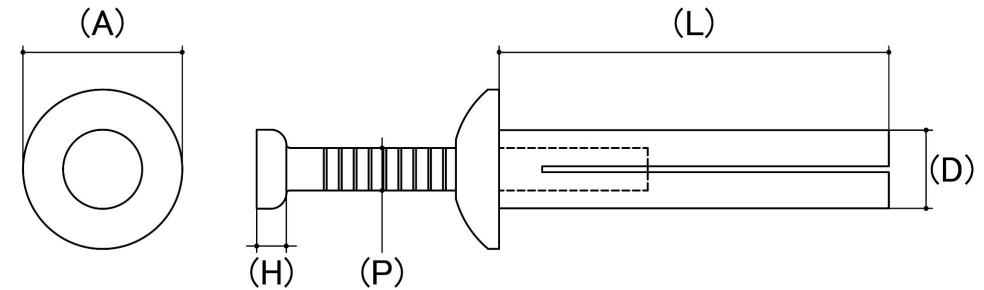

*CAD drawings shown for graphic representation only.**

Size	Length (mm)	Anchor Length (L) (mm)	Embedment Depth (mm)	Min Base Material Thick (B) (mm)	Max Fast Thickness (G) (mm)	Pin Diameter (P) (mm)	Drill Hole Size (mm)	sku (qfind)
	Nom	Nom	Nom	Nom	Nom	Nom	Nom	
M5	22	22	20.00	25.00	2.00	3.00	5.00	65MM522
M6.5	25	25	20.00	25.00	5.00	4.00	6.50	65MM6525
M6.5	32	32	25.00	35.00	7.00	4.00	6.50	65MM6532
M6.5	38	38	30.00	40.00	8.00	4.00	6.50	65MM6538
M6.5	50	50	35.00	45.00	15.00	4.00	6.50	65MM6550

Disclaimer:

Dimensional data and technical information was obtained from publically available sources and not acquired through standard agencies. It has been completed and compiled for reference purposes only; where discrepancies are found they are subject to change without notice. Bolt & Nut Australia makes no warranties or representations regarding the accuracy and validity of the compiled information and data. Contact the relevant standard authorities for accurate and detailed information.

* CAD drawings may not reflect diameter, thread length or overall length.

© Bolt & Nut Australia Pty Ltd. All rights reserved.

Version: 18 Mar 2024